



## High Elms

Harpenden, AL5 2JU

Spacious and beautifully presented detached four-bedroom family home of circa 2,857 sq ft set on circa 1/3-acre gated plot on this much sought-after private road located in Hatching Green in the popular West Common area. Immaculately presented throughout, including Principal suite with dressing room and en-suite, Playroom/Gym with double-height, vaulted ceiling (with potential to add a mezzanine floor creating an opportunity for a fifth bedroom) and a super open-plan Kitchen/Dining room leading onto a generous garden. Moments from the Rothamsted Estate and within easy reach of Harpenden town centre and station.

**Guide price £2,350,000**

# High Elms

Harpenden, AL5 2JU



- Detached four bedroom home
- Gated entrance
- Four bathrooms, Five reception rooms
- Council Tax Band H
- Prime West Common location
- 0.27-acre plot
- Close to Harpenden Town centre & station
- Sought after private road
- Circa 2,857.2 sq ft
- Secluded private position, set back from the road

## Reception Hall

18'7" x 14'0" (5.67 x 4.29)

## Kitchen/Dining Room

25'10" x 17'1" (7.89 x 5.22)

## Utility Room

8'2" x 8'1" (2.51 x 2.47)

## Study

14'0" x 9'11" (4.27 x 3.03)

## Sitting Room

17'1" x 15'7" (5.22 x 4.76)

## TV Room

13'10" x 12'3" (4.24 x 3.74)

## Play Room

17'6" x 13'6" (5.35 x 4.13)

## Cloakroom

## Garage

17'1" x 9'6" (5.21 x 2.92)

## Landing

## Bedroom One

15'7" x 15'3" (4.76 x 4.65)

## Dressing Room

En-suite with bath & shower

## Bedroom Two

14'9" x 10'9" (4.50 x 3.30)

En-suite with shower

## Bedroom Three

16'7" x 10'0" (5.07 x 3.05)

En-suite with shower

## Bedroom Four

13'8" x 10'1" (4.18 x 3.08)

## Bathroom





# Floor Plan

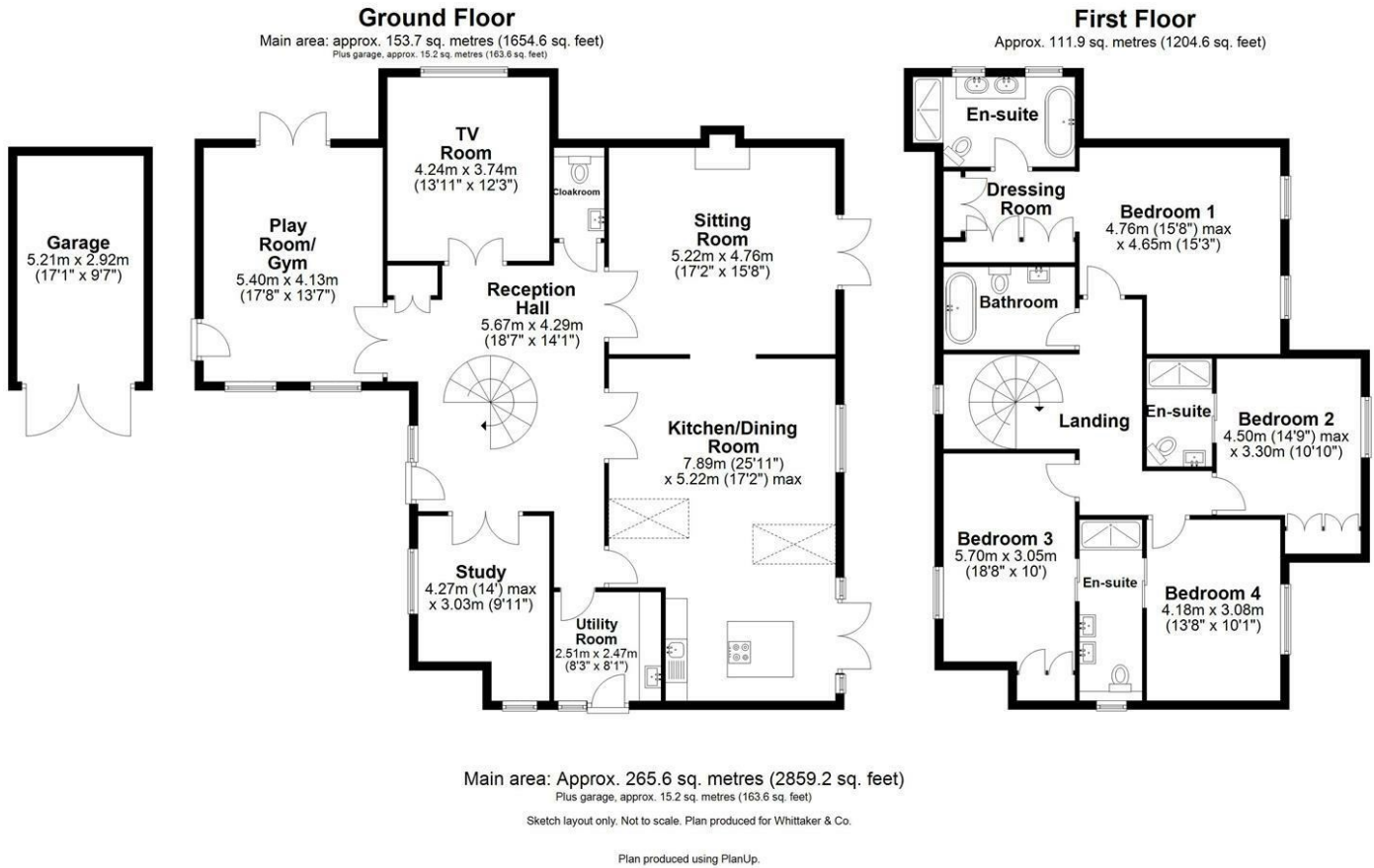

These particulars, whilst believed to be accurate are set out as a general outline only for guidance and do not constitute any part of an offer or contract. Intending purchasers should not rely on them as statements of representation of fact, but must satisfy themselves by inspection or otherwise as to their accuracy. No person in this firm's employment has the authority to make or give any representation or warranty in respect of the property.

